

**LEVER BODY**

Die-cast zinc alloy, epoxy resin coating, RAL 9005 black colour, matte finish.

**DISTANCE BUSHING**

Nitrided tempered steel with balls allowing a greater efficacy of the clamping force.

**STANDARD EXECUTIONS**

Black-oxide steel clamping element and retaining screw. Steel return spring.

- Threaded hole.
- Threaded stud, length as shown in the table.

**FEATURES AND APPLICATIONS**

Adjustable handles GN 300.4 allow a higher tightening clamp force. The clamping element is not in direct contact with the plane to be clamped. Clamping is made by the distance bushing with large base, which does not rotate on the plane. The bushing contains a set of balls which reduce to a minimum friction between the part which rotates with the lever during clamping and the distance bushing.

**SPECIAL EXECUTIONS ON REQUEST**

Lever in different colours.

**INSTRUCTIONS OF USE**

For clamping, lift the lever to disengage the clamping device teeth and bring it back to start position. By releasing the lever, the return spring automatically engages the teeth.

If the lever cannot make a 360° rotation, the clamping element can be easily screwed by means of the hexagon socket front head screw (after having disengaged the lever).

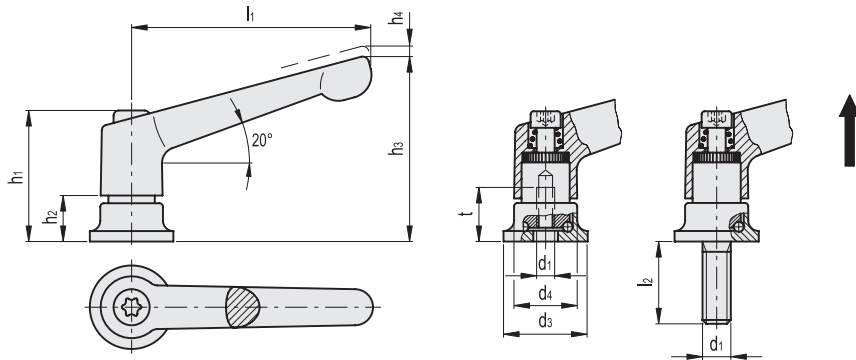

Conversion Table			
1 mm = 0.039 inch			
l1			
mm	inch	mm	inch
63	2.48	92	3.62
78	3.07	108	4.25

METRIC

Code	Description	l1	d1	d3	d4	h1	h2	h3	h4	tmin	⚖️
GN.15531	GN 300.4-63-M6-SW	63	M6	24	17.5	34.5	11	48.5	4	12.5	96
GN.15551	GN 300.4-78-M8-SW	78	M8	25	21	39.5	11.5	58.5	4	14	140
GN.15571	GN 300.4-92-M10-SW	92	M10	30	24	46.5	13.5	68.5	4	18	205
GN.15591	GN 300.4-108-M12-SW	108	M12	35	30	56.5	18	82	5	26.5	325

Code	Description	l1	d1	d3	d4	h1	h2	h3	h4	l2	⚖️
GN.15601	GN 300.4-63-M6-20-SW	63	M6	24	17.5	34.5	11	48.5	4	20	99
GN.15603	GN 300.4-63-M6-27-SW	63	M6	24	17.5	34.5	11	48.5	4	27	103
GN.15611	GN 300.4-78-M8-21-SW	78	M8	25	21	39.5	11.5	58.5	4	21	152
GN.15613	GN 300.4-78-M8-36-SW	78	M8	25	21	39.5	11.5	58.5	4	36	156
GN.15621	GN 300.4-92-M10-29-SW	92	M10	30	24	46.5	13.5	68.5	4	29	218
GN.15625	GN 300.4-92-M10-47-SW	92	M10	30	24	46.5	13.5	68.5	4	47	223
GN.15633	GN 300.4-108-M12-34-SW	108	M12	35	30	56.5	18	82	5	34	366
GN.15634	GN 300.4-108-M12-50-SW	108	M12	35	30	56.5	18	82	5	50	382
GN.15635	GN 300.4-108-M12-57-SW	108	M12	35	30	56.5	18	82	5	57	389
GN.15636	GN 300.4-108-M12-65-SW	108	M12	35	30	56.5	18	82	5	65	397
GN.15637	GN 300.4-108-M12-85-SW	108	M12	35	30	56.5	18	82	5	85	417

- 1
- 2
- 3
- 4
- 5
- 6
- 7
- 8
- 9
- 10
- 11
- 12
- 13
- 14
- 15
- 16
- 17
- 18

Clamping levers